

**STRUCTUS™**

BUILDING TECHNOLOGIES

The leader in high-performance drywall corner solutions.

**HYDROTRIM™**

*Water-activated, self-adhesive drywall corner trim.*



*HYDROTRIM is an easy-to-apply corner that does not blister, bubble, dent or crack. HYDROTRIM's patented design includes a water activated adhesive and punch holes that allow joint compound to further bond the corner to the drywall.*

**Fast & Easy to Apply**

*Simply spray with water, press on. No screws, staples or adhesive spray needed!*

**Superior Bond**

*Water-activated adhesive creates an indestructible bond to drywall; perforated holes allow joint compound to permanently seal corner to wall.*

**Will NOT Dent or Crack**

*Paper-plastic-paper tapered design holds up to impacts and will not rust.*

*Simply spray it with water...*



*press on and finish.*

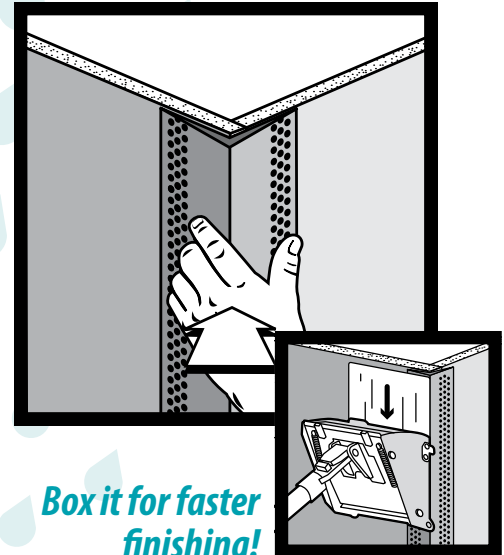

*For more information visit [www.hydrotrimcorner.com](http://www.hydrotrimcorner.com)*

# IMPORTANT: READ BEFORE INSTALLING HYDROTRIM

Saturate the entire adhesive surface with clean, plain, tap water

NO



Do NOT use a Sponge

YES

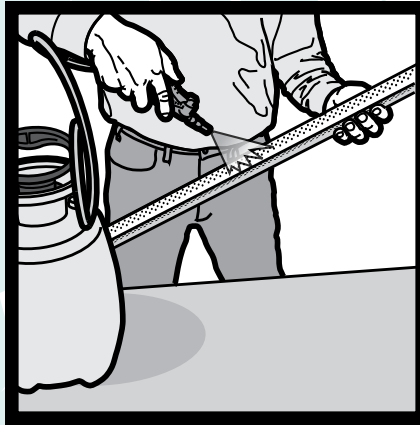

Use a Pump Sprayer or Spray Bottle

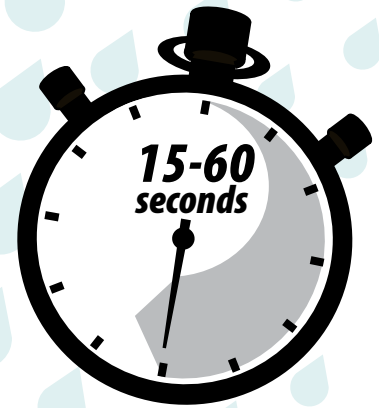

Allow 15-60 seconds activation time before installing

## PREPARATION

**IMPORTANT:** Refer to the preparation/framing instructions located on the HYDROTRIM box for the correct way to hang the drywall panels.

## INSTALLATION

For best installation results follow these steps:

**STEP 1** - Saturate adhesive side of corner completely with clean, plain, tap water using a spray pump. **IMPORTANT:** Do Not use a sponge to apply water to the adhesive of the HYDROTRIM.

Make sure the entire adhesive surface of the HYDROTRIM corner is completely wet.

**STEP 2** - Allow 15 - 60 seconds adhesive activation time before installing corner. Adhesive should be tacky to touch. Activation time will vary depending upon room temperature, humidity and temperature of water in your pump sprayer.

**CAUTION:** do not soak HYDROTRIM corners.

**STEP 3** - Place wetted, adhesive side of corner on wall and align.

**STEP 4** - Using HYDROTRIM

Roller, firmly press corner making sure flanges are fully contacted and bonded to drywall surface.

**REPOSITIONING:** The HYDROTRIM corner may be removed, re-wetted and repositioned if adhesive has not set-up.

**IMPORTANT:** Once adhesive has set-up, the HYDROTRIM corner cannot be repositioned and will be permanently bonded to the drywall.

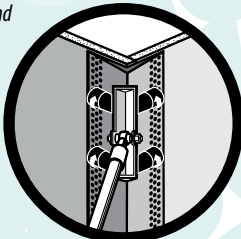

Use the HYDROTRIM roller for best results

## INSTALLATION TIPS

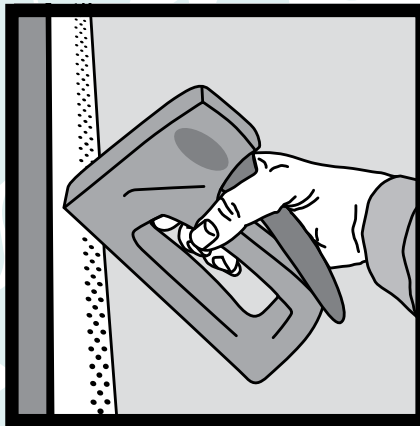

**TIP:** If the corner flange floats or lifts due to poor hanging or inadequate water coverage, staple the flange to ensure it will lay completely flush against the drywall.

**TIP:** Snap chalk lines to ensure straight corners on bulkheads and long runs.

**TIP:** Corners can be cut to length using scissors, metal snips or a chop saw.

**TIP:** Use a chop saw to cut multiple pieces of HYDROTRIM corners in a bundle to the same length at one time.

## FINISHING

The HYDROTRIM corner can be mudded immediately after application using base coat joint compound. If boxing, wait until adhesive has set-up.

Using a taping knife, apply base coat joint compound over the HYDROTRIM corner, filling the holes. Let dry.

Using a finishing knife, skim over the HYDROTRIM corner once more with final coat joint compound. Let dry. Sand and paint.

**NOTE:** always follow manufacturers recommendations when jointing plasterboard.

## Box it for faster finishing!

HYDROTRIM corners were designed so that they can also be boxed, resulting in faster and more convenient finishing. HYDROTRIM corner trim uses 15- 30% less mud than bead, so you won't run out of mud before you're done boxing your corner.

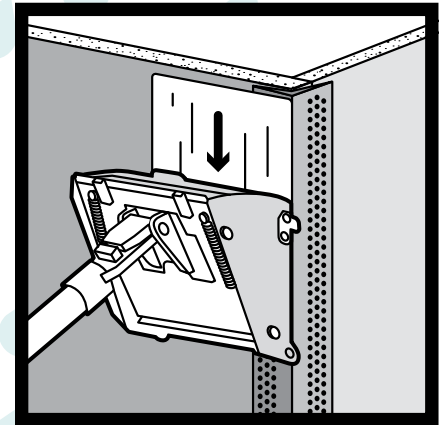

Distributed by

**GRABBER**  
CONSTRUCTION PRODUCTS

A 100% Employee Owned Company

[www.grabberman.com](http://www.grabberman.com)

For more information visit [www.hydrotrimcorner.com](http://www.hydrotrimcorner.com)

